

Rear Seat COMPONENTS

VAN (STD): 3/6-Seater model

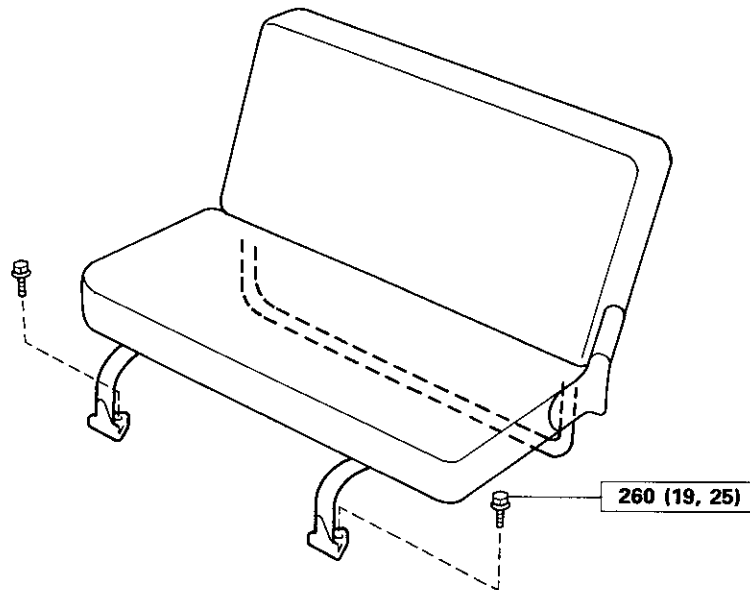

VAN (DX): 3/6-Seater model

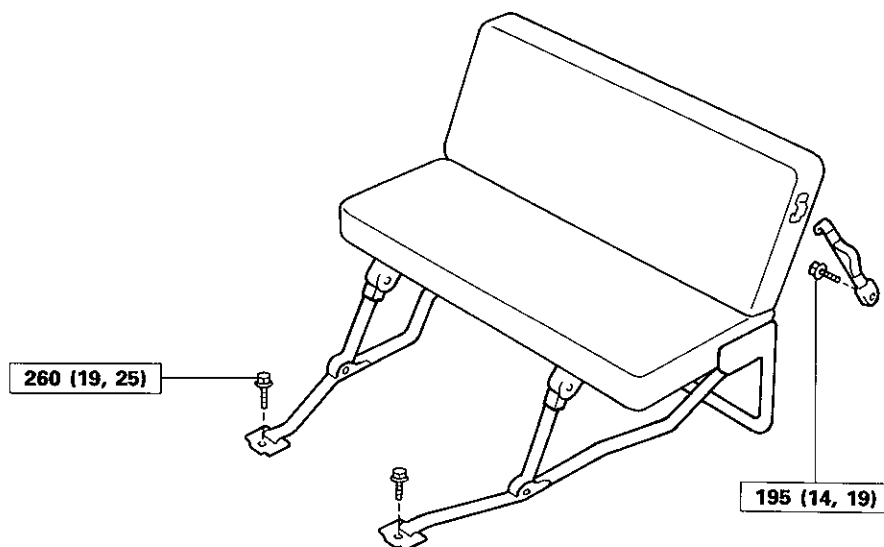

kg-cm (ft-lb, N-m) : Specified torque

COMPONENTS (Cont'd)

VAN (Supper GL): 3/6-Seater model

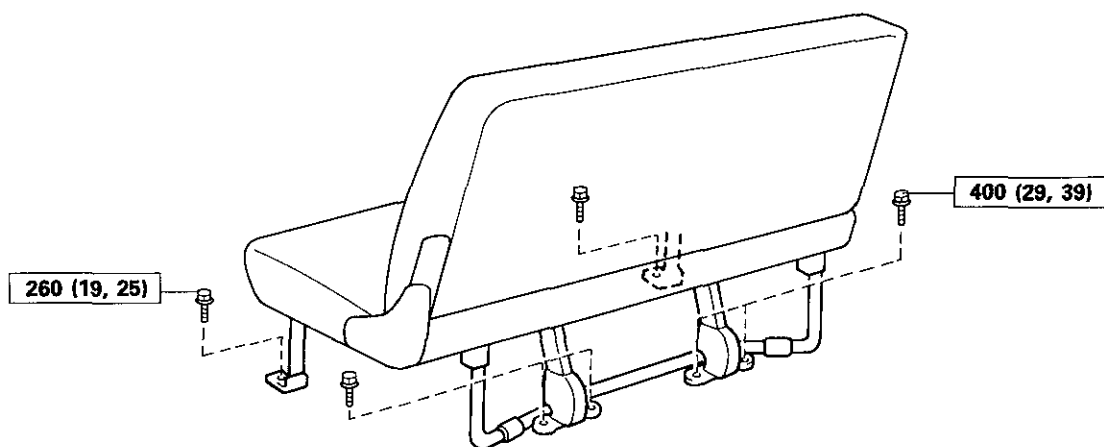

VAN: for Norway

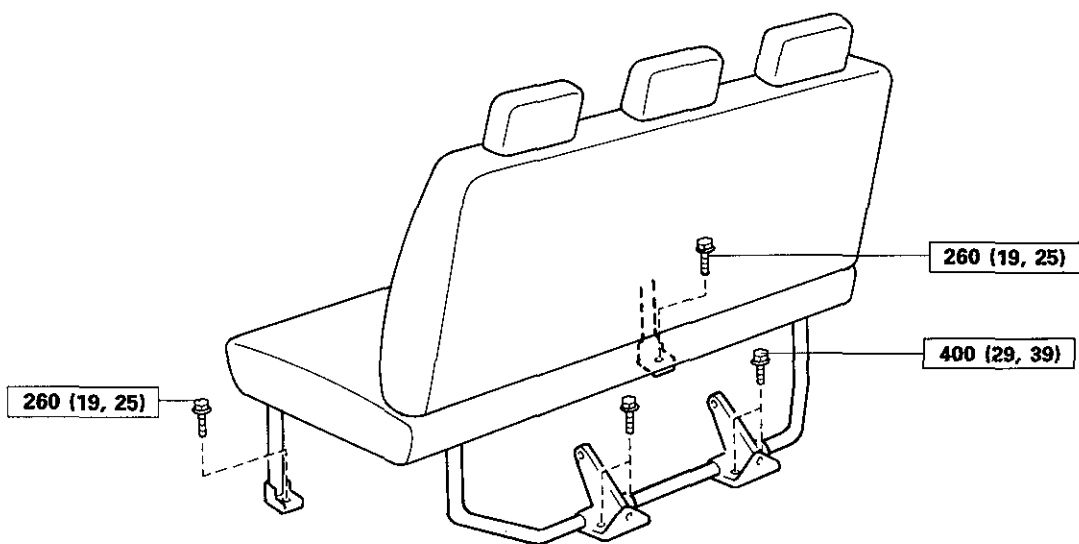

kg-cm (ft-lb, N·m) : Specified torque

COMPONENTS (Cont'd)

VAN: Europe 3/6/9-Seater model

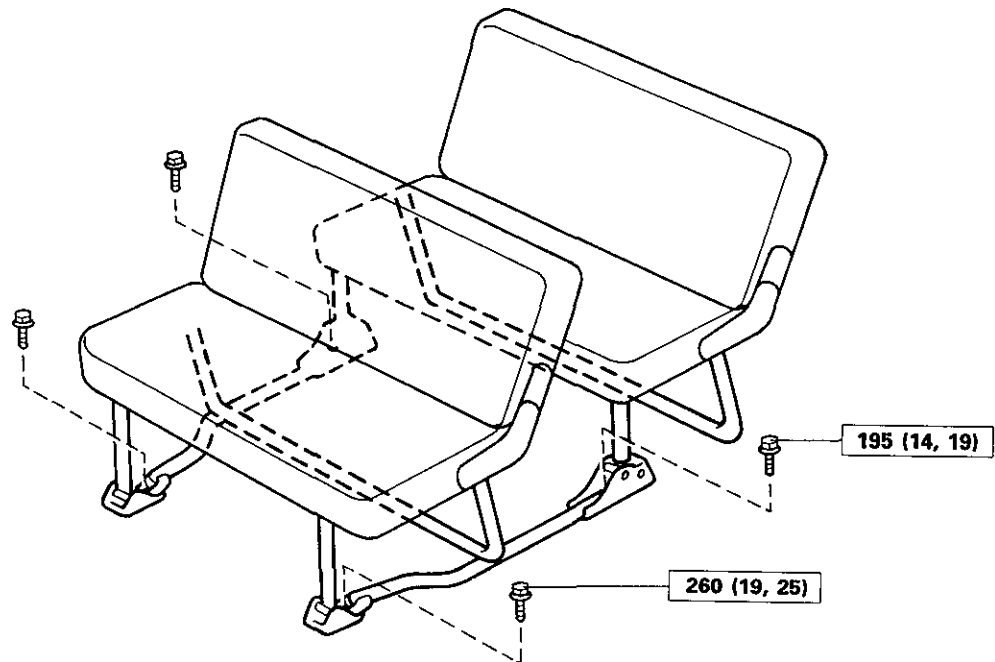

VAN: Europe 6/9-Seater model

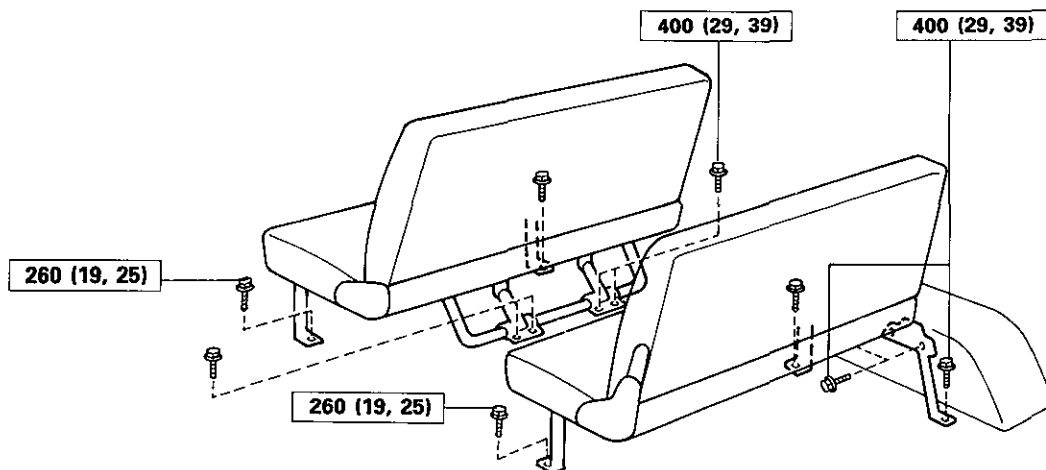

COMPONENTS (Cont'd)

COMMUTER: Rear No.4 3-Seater model (Fall Forward type)

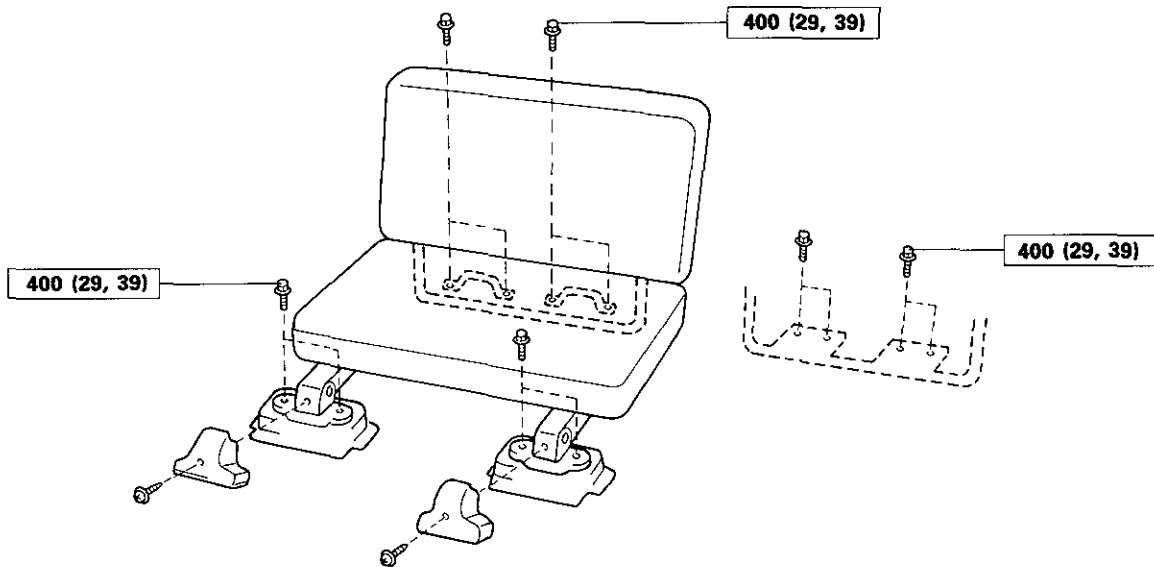

COMMUTER: 12-Seater model

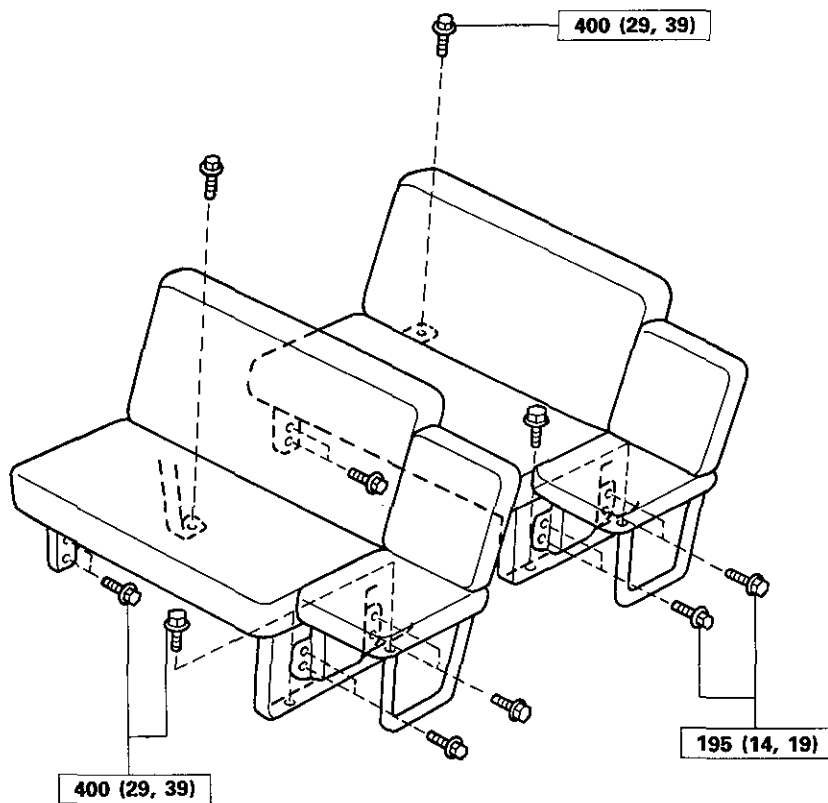

kg-cm (ft-lb, N-m) : Specified torque

COMPONENTS (Cont'd)

COMMUTER: 15-Seater model

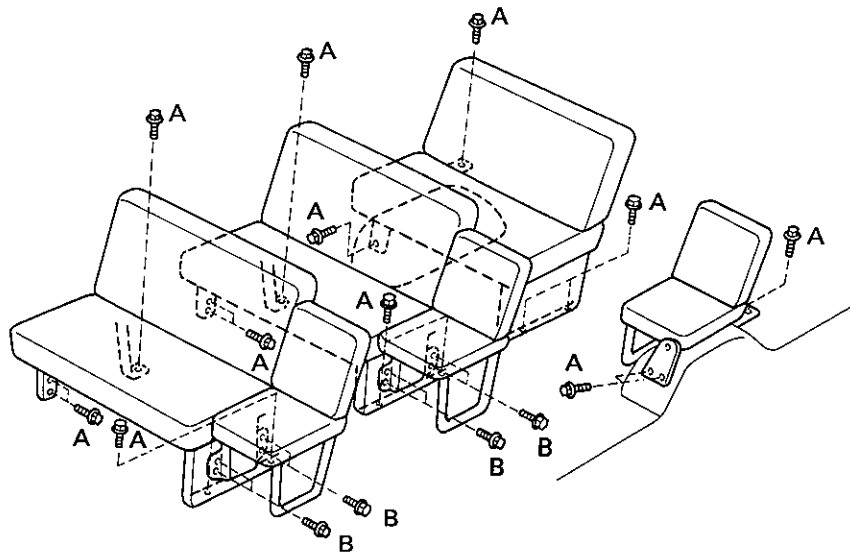
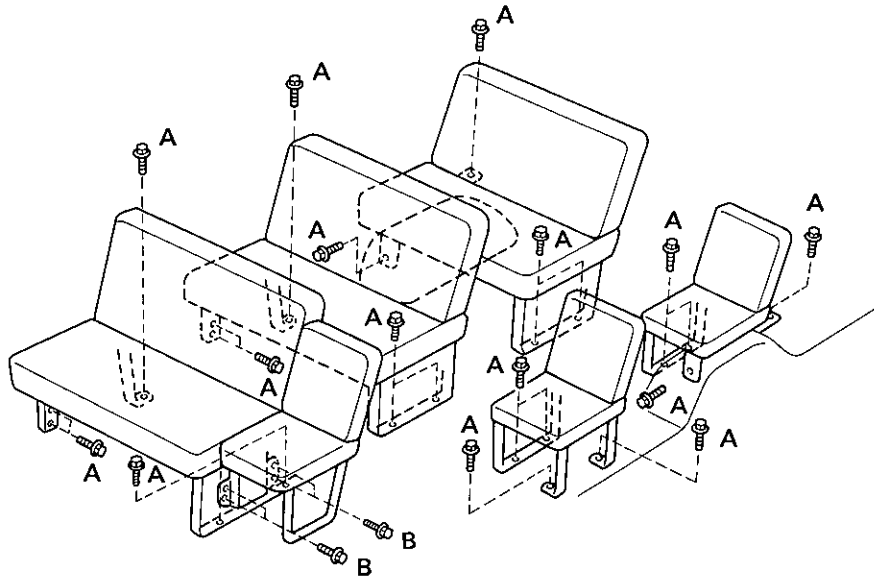

A: 400 (29, 39)

B: 195 (14, 19)

kg-cm (ft-lb, N-m) : Specified torque